

COMITROL® DISC MILL 380 (DM380)

SUCCESSFUL MILLING OF NUTS & SEEDS

The Comitrol Disc Mill 380 (DM380) is ideal for processing nuts in small batches or high-volume continuous production. The unique disc plate design and adjustable gap setting allow for a wide variety of nuts to be processed. The machine reduces whole/split nuts into a flowable nut paste or nut butter. Butter texture is controlled through the type of plates used and the gap adjustment.

DM380 can be employed as a high-capacity pre-mill in conjunction with one of the Comitrol Processor machines to produce a smooth finished product. The DM380 may also be used on its own to produce coarse to fine products including 'homestyle' nut butter.

The DM380 features an integrated product feed hopper and a variable speed driven screw feeder for ease of use and versatility. Screw feeder offers quick removal design. Compact hinged door design allows for full access to simplify routine cleaning and maintenance. Robust, heavy-duty construction. Sanitary stainless steel construction. The machine is built for uninterrupted continuous operation. Safety features include machine standstill monitor, safety sensors, and guardlocks to ensure safe operation and access.



(Machine shown with optional stainless steel frame and discharge hopper extension.)

TYPES OF CUTS

COARSE/FINE PARTICLES

Particle sizes ranging from coarse to fine are possible. Please contact Urschel Asia Pacific for a free-of-charge test-cut to find the most efficient solution to your size reduction needs.

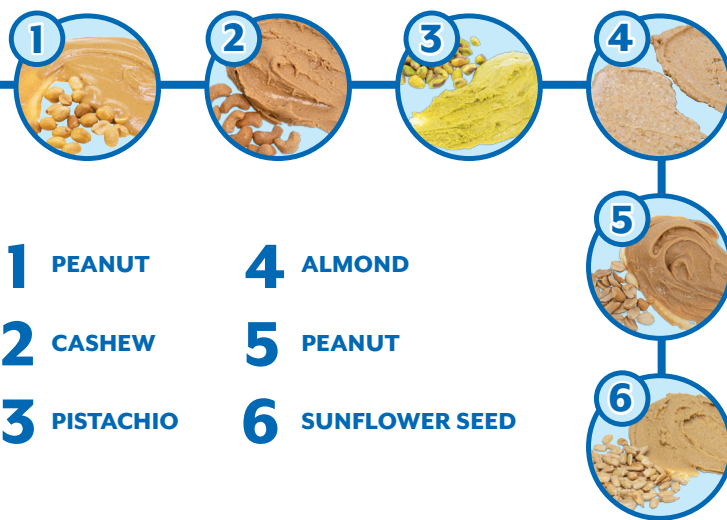

1 PEANUT

4 ALMOND

2 CASHEW

5 PEANUT

3 PISTACHIO

6 SUNFLOWER SEED

CUTTING OVERVIEW



Product texture is controlled through the type of plates used and the gap adjustment

If your product application is not mentioned on this page, contact your local Urschel representative to determine the most effective solution to your size reduction needs.

COMITROL® DISC MILL 380

Measurements and weights may vary depending on machine configuration.

Length: 65.35" (1660 mm)

Width: 43.31" (1100 mm)

Height: 29.92" (760 mm)

Net Weight: 1722 lb (781 kg)

Motors: 40 HP (29.8 kW)

Screw Feeder –

2 HP (.75 kW) gearmotor

equipped with VFD

(variable frequency drive)

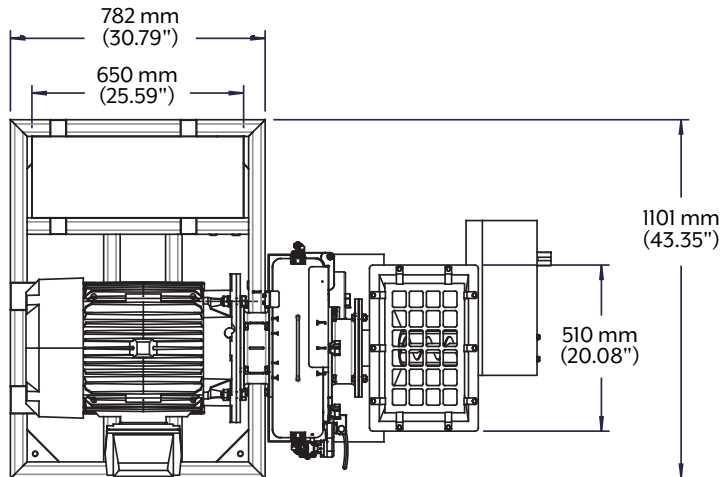

NOTE: Products that are explosive or create a potentially explosive atmosphere should not be processed by any standard Urschel machine. A potentially explosive atmosphere could be created if processing your product creates fumes or dust in sufficient concentrations. In such cases, customers may work with Urschel to develop a customized solution through a certified print (CP) process.

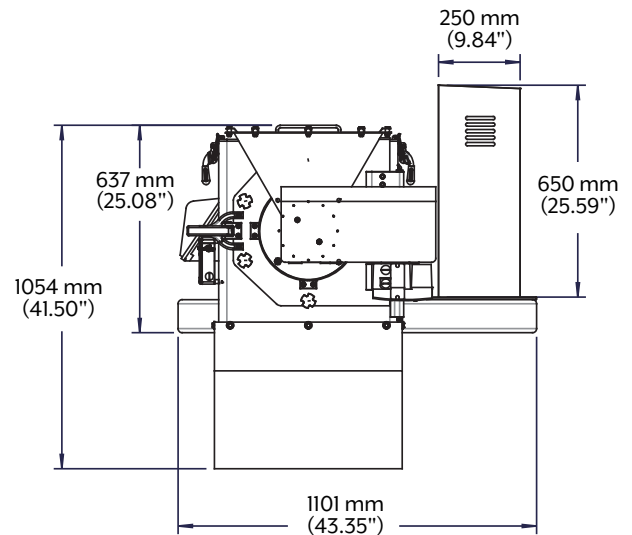
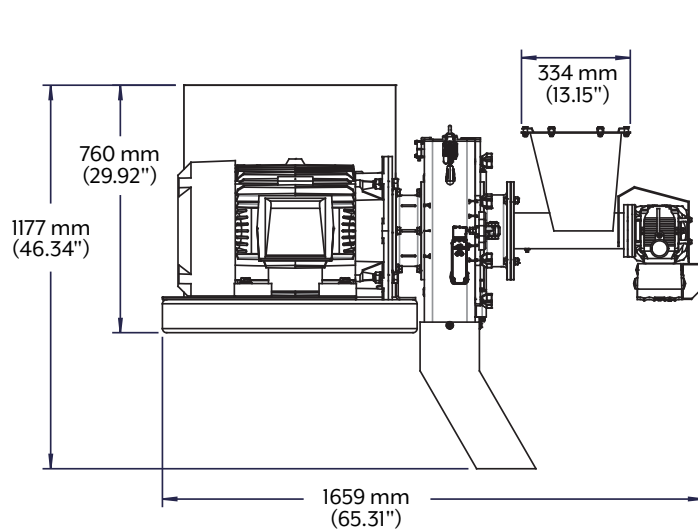

SPECIFICATIONS & DIMENSIONS

TEST CUT YOUR PRODUCT

Contact Urschel Asia Pacific Pte. Ltd. to schedule a comprehensive, no-obligation test-cut of your product: asia@urschel.com



URSCHEL®
The Global Leader in Food Cutting Technology

asia@urschel.com | 65-6254-7757 | 10 Tagore Lane, Singapore 787473